



Model Number:
TEEL1-4002

RF Components

L-Band Bias TEE

- 48V & 500mA DC rated
 - Fitted with LED bias indicator
- Available with RF connector options:
- 50 Ω SMA
 - 50 Ω N-type
 - 50 Ω BNC
 - 75 Ω BNC
 - 75 Ω F-type.

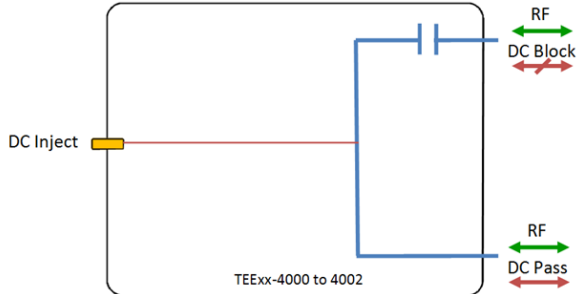

Flexible Mounting
Tapped screw & through hole mounting options

Compact
housed in rugged compact enclosure

DC
External DC powering

850-2150 MHz
operating frequency range. L-Band ready



Bias Tee

RF Parameters					
TEEL1-4000-XXXX	S5S5	N5N5	B5B5	B7B7	F7F7
Frequency Range	850 - 2150 MHz				
RF Connectors	50Ω SMA	50Ω N-Type	50Ω BNC	75Ω BNC	75Ω F-Type
Mean Insertion Loss (dB)	0.2±0.2	0.2±0.2	0.2±0.2	0.6±0.3	0.6±0.3
Flatness ± (dB)	0.3	0.3	0.3	0.5	0.5
Input Return Loss (dB)	16	16	15	10	10
	14	14	14	8	8
Output Return Loss (dB)	16	16	15	10	10
	10	10	10	8	8

Broadcast



Marine Oil & Gas



SNG & VSAT



Satellite Teleport



Technical specifications and operating parameters

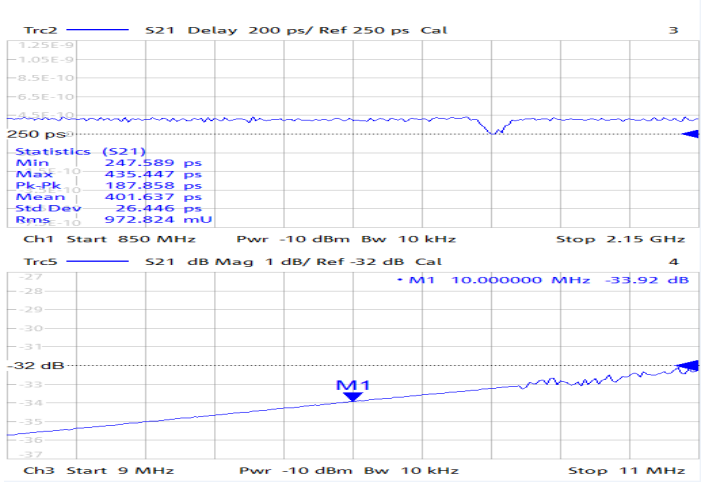
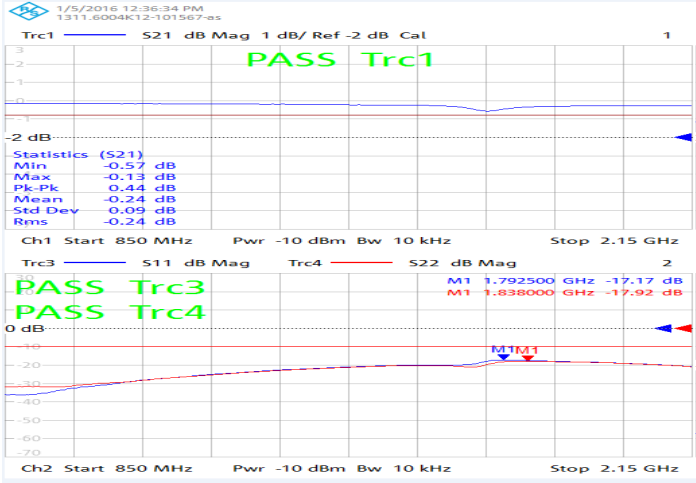

Environmental	
Operating Temperature	0°C to 45°C
Storage Temperature	-20°C to +75°C
Location	Indoor use Only
Humidity	85% non-condensing
Altitude	10,000 feet

Max Operating Parameters	
Input RF Power	+37 dBm (125mW)
DC Voltage	48V on any RF port
DC Current	0.5A

! Operation beyond these limits may cause instantaneous and permanent damage.

Physical Dimensions

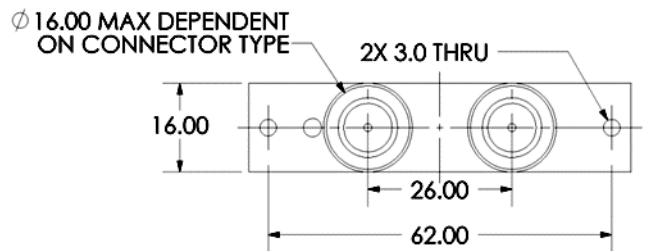
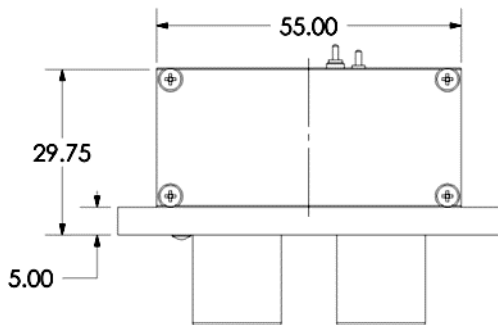

Note 1: The specification is subject to regular reviews and will be updated from time to time as part of our continuing product development and improved spec accuracy.
Note 2: Operation beyond the quoted limits stated above may cause instantaneous and permanent damage.



RF Components

Model Number:
TEEL1-4002
 10MHz L-Band Bias Tee

DC Connector Options

We are able to offer the following options for connecting external DC power supplies:

Option 1

As standard our units are supplied with a feed-thru port for external soldering of power supply cable.

Option 2

For a Male Molex DC connector supplied on the Bias TEE please use the model number and add "/1" eg. TEEL1-4007-N5N5/1

Option 3

For a Female Molex socket and cable assembly please use the model number: CABMLX-1500-F or refer to the ETL accessories section on our website.



External Power Supplies

PSU Range			
Model Number	Input	Output	Other
PSU12F125-9701-SLP	100-240V (AC), 0.6A	12V (DC), 1.25A	Solder pin output
PSU12F125-9701-ML2			Female 3 pin Molex socket
PSU18F500-971001-SLP	90-264V (AC), 1.2A max	18V (DC), 5A max	Solder pin output
PSU18F500-971001-ML2			Female 3 pin Molex socket
PSU24F100-971002-SLP	90-264V (AC), 0.6A	24V (DC), 1 A	Solder pin output
PSU24F100-971002-ML2			Female 3 pin Molex socket
Pricing available on request			

PSU12F125-9701



Broadcast



Marine Oil & Gas



SNG & VSAT



Satellite Teleport

