



RF Components

Model Number:
COM06L1P-2610

6-Way L-Band Passive Splitter/Combiner

850 - 2150 MHz

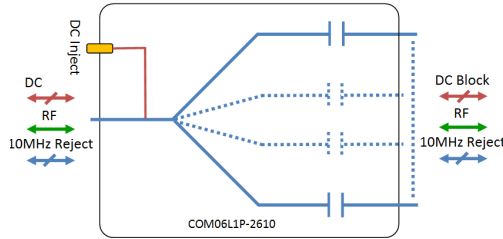

- LNB inject on common port
- All RF ports 10MHz & DC blocked

Available with RF connector options:

- 50 Ω SMA
- 50 Ω N-type
- 50 Ω BNC
- 75 Ω BNC
- 75 Ω F-type.



RF Parameters						
COM06L1P-2610-XXXX	S5S5	N5N5	B5B5	B7B7	F7F7	
Frequency Range	850-2150 MHz					
RF Connectors	50 Ω SMA	50 Ω N-Type	50 Ω BNC	75 Ω BNC	75 Ω F-Type	
Insertion Loss (dB)	Typ.	1.0	1.0	1.3	1.5	1.5
	Max	1.5	1.5	1.8	2.0	2.0
Flatness \pm (dB)	0.5	0.5	0.6	1.0	1.0	
Input Return Loss (dB)	Typ.	15	15	13	10	10
	Min	12	12	12	8	8
Output Return Loss (dB)	Typ.	18	18	15	12	12
	Min	12	12	10	8	8
Isolation (dB)	Typ.	20	20	20	20	20
Amplitude Balance (dB)	≤ 0.5	≤ 0.5	≤ 0.5	≤ 1.0	≤ 1.0	
Phase Balance (Φ)	$\leq 3^\circ$	$\leq 4^\circ$	$\leq 4^\circ$	$\leq 10^\circ$	$\leq 10^\circ$	

The given Insertion Loss specified is the loss above the theoretical limit for a lossless divider. For 6-way splitters theoretical value is 7.8dB
 10MHz Rejection is 60dB*
 *To ports which are applicable

Broadcast



Marine Oil & Gas



SNG & VSAT



Satellite Teleport





RF Components

Model Number:
COM06L1P-2610

6-Way L-Band Passive Splitter/Combiner

Technical specifications and operating parameters

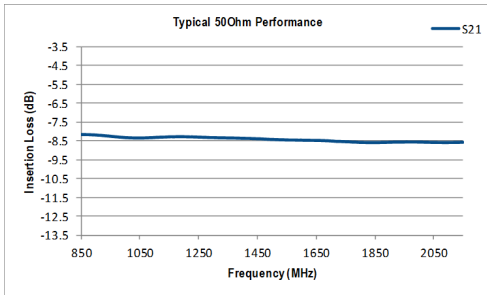

Insertion Loss (dB)

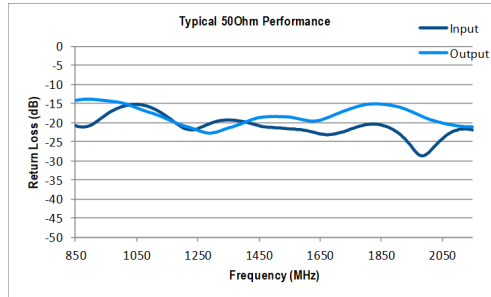

Return Loss (dB)

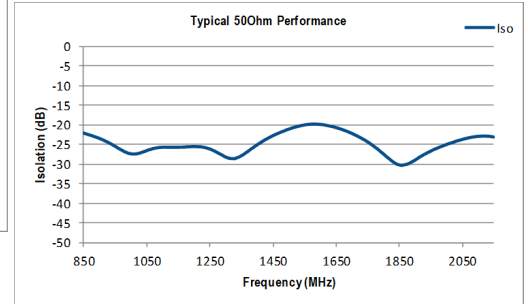

Isolation (dB)

Environmental	
Operating Temperature	0°C to 45°C
Storage Temperature	-20°C to +75°C
Location	Indoor use Only
Humidity	85% non-condensing
Altitude	10,000 feet

Max Operating Parameters	
Input RF Power	+37 dBm (5W) As Splitter
Input RF Power	+33 dBm (2W) As Combiner
DC Voltage	35V on any RF port
DC Current	N/A

! Operation beyond these limits may cause instantaneous and permanent damage.

Physical Dimensions (mm)

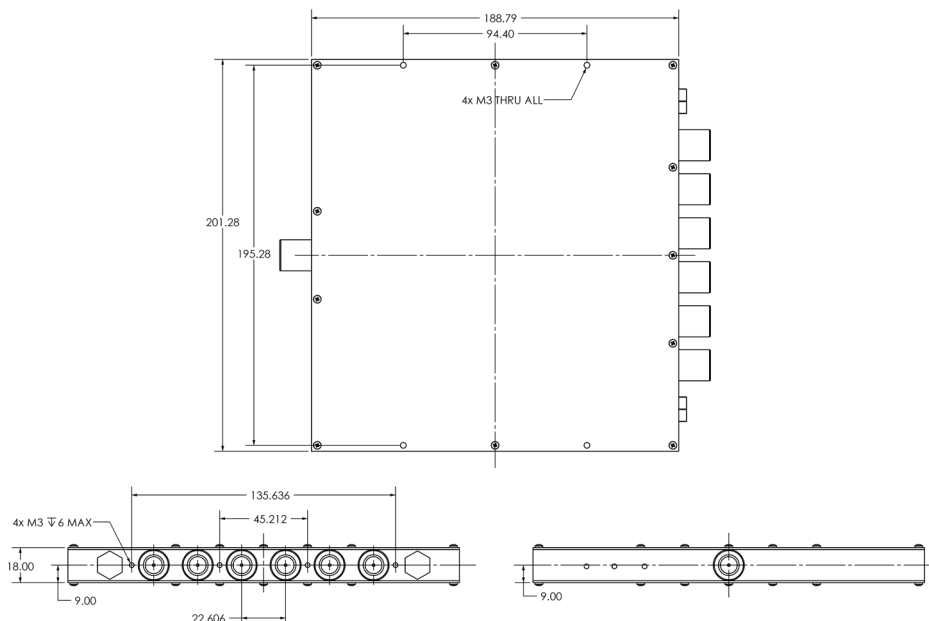

Note: The specification is subject to regular reviews and will be updated from time to time as part of our continuing product development and improved specification accuracy.

ETL SYSTEMS LIMITED
Coldwell Radio Station
Madley
Hereford
England HR2 9NE

TELEPHONE
+44 (0)1981 259020

EMAIL
info@etlsystems.com

FACSIMILE
+44 (0)1981 259021

WEB
www.etlsystems.com

